



# Electric range with Gastronorm oven



## CE 741 E.

Electric cooker, 4 electric hotplates,  
1 Gastronorm 1/1 electric oven.

- Body and front in stainless steel.
- Stainless steel legs with adjustable feet. Height: 150/175 mm.
- Total power: 10.1 kW.
- Electrical supply: three-phase 400V + N + E.
- 400 V without N phase as an option - Additional cost.

### Hob

- Dimensions: 700 x 650 mm.
- 2 x 2 kW hotplates, Ø 180 mm.
- 2 x 1.5kW hotplates, Ø 145 mm.

### Oven

- Interior dimensions: W 530 - D 400 - H 305 mm.
- Power of heating elements:  
Base + periphery roof: element: 3.1 kW- Grill: 2.85 kW.
- Thermostat.
- Standard equipment: 1 oven rack.

**CE 741 E**

W 700 - D 650 - H 900

### Variations:

**OVEN** (instead of static electric oven)

**SFCT 530** 1 convection oven (3.4 kW)

**SGE 530** Electric grill (in convection oven)

# 4 electric hotplates, 1 Gastronorm 1/1 electric oven. CE 741 E

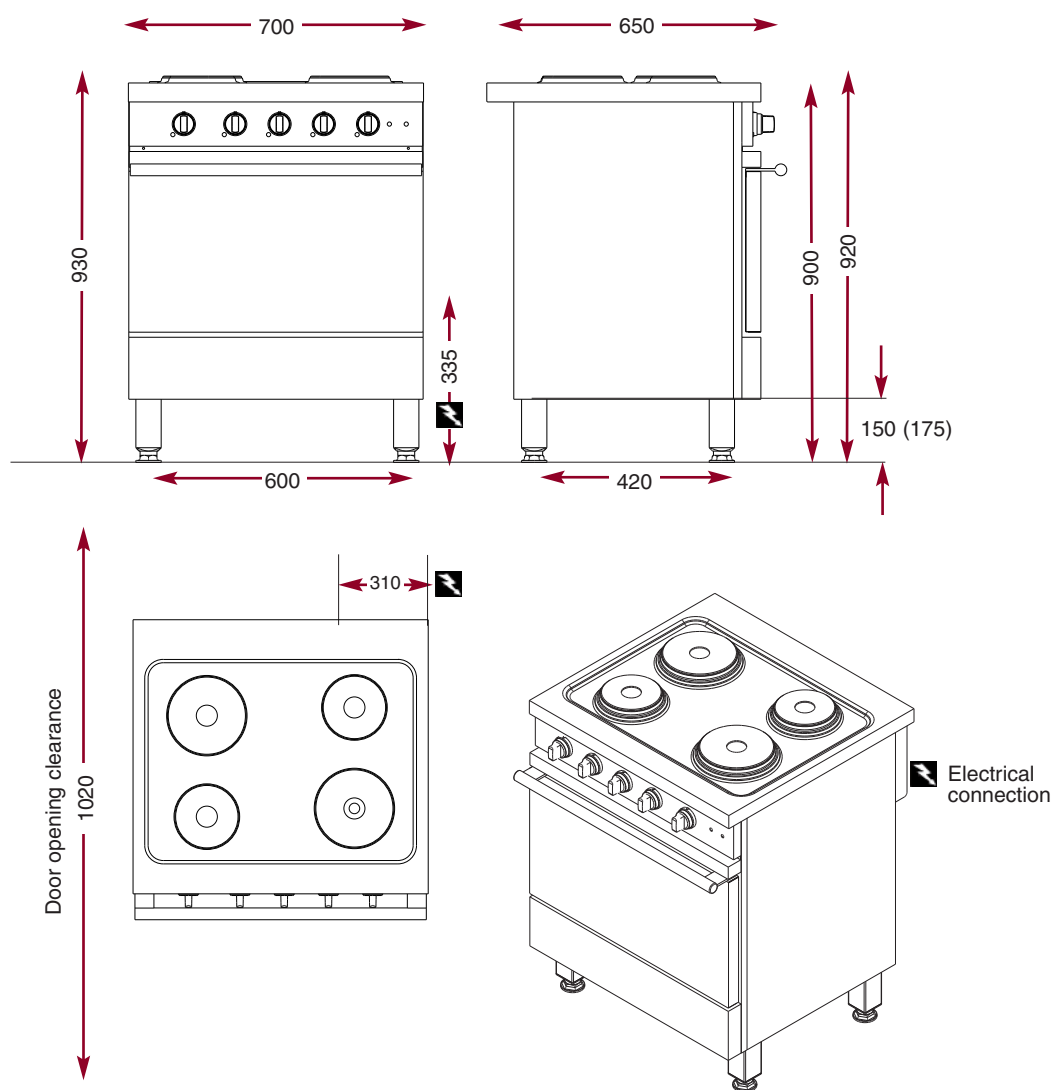

Electric hotplates.

The hobs of the electric cookers are fitted with cast iron electric hotplates or vitroceramic radiant rings. The static electric or convection electric ovens are finished in smooth antiacidic enamel.



*The Chef's Choice.*